

**CMF95 Series**

Single Stage Condensing Downflow Gas Furnace

95.1% AFUE

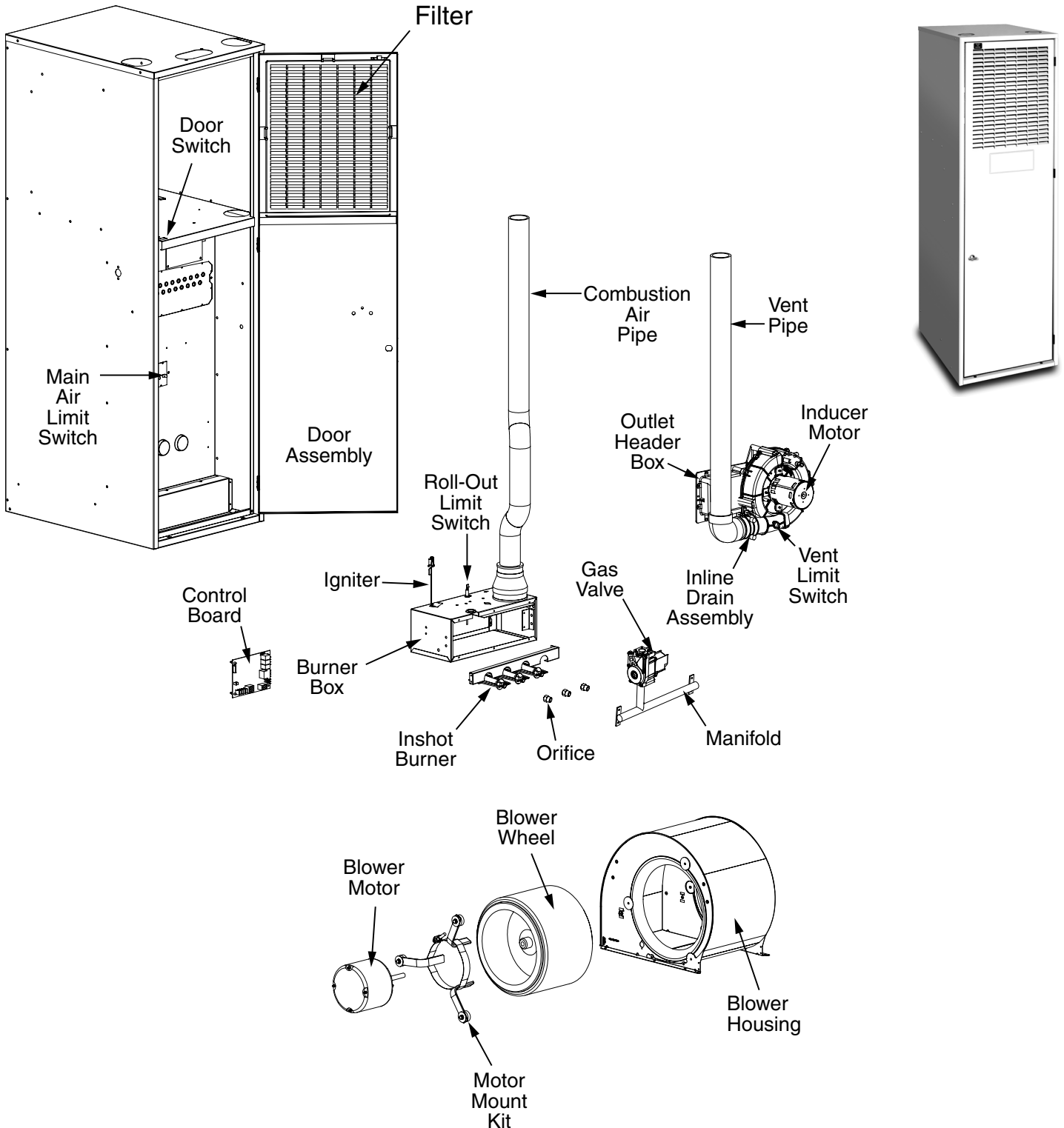

**95.1% AFUE****CMF95 DOWNFLOW GAS FURNACE**

| DESCRIPTION   | 045T PG  | 072T PG  |
|---|----------|----------|
| Blower Deck Limit Switch (Not Shown)  | 626602R  | 626602R  |
| Blower Housing  | 297217R  | 297217R  |
| Blower Motor  | 1032131R | 1032133R |
| Blower Wheel  | 667258R  | 667258R  |
| Burner Assembly   | 921495   | 921496   |
| Burner View Port (Not Shown)  | 632216R  | 632216R  |
| Combustion Air Pipe   | 664645R  | 664645R  |
| Control Board (Nordyne/UTEC)  | 1021573R | 1021573R |
| Control Board (Emerson)<br><i>NOTE: For units manufactured after 09/07/2022</i>           | 1041648R | 1041648R |
| Door Assembly   | 921489   | 921489   |
| Door Switch   | 632337R  | 632337R  |
| Drain Tube (Soft, 42") (Not Shown)  | 664278R  | 664278R  |
| Drain Tube (Hard "J") (Not Shown)   | 663706R  | 663706R  |
| Drain Tee (Not Shown)   | 618060R  | 618060R  |
| Filter  | 669925R  | 669925R  |
| Flame Sensor (Not Shown)  | 903600   | 903600   |
| Fuse (Not Shown)  | 632261R  | 632261R  |
| Gas Valve   | 903596   | 903596   |
| Heat Exchanger (Not Shown)  | 921492   | 921493   |
| Igniter   | 1016290S | 1016290S |
| Inducer Motor (with Gasket)   | 921494   | 921494   |
| Inducer Orifice (Not Shown)   | 669927R  | 669926R  |
| Inline Drain Assembly   | 664435R  | 664435R  |
| Inshot Burner   | 661135R  | 661135R  |
| Main Air Limit Switch   | 1018776R | 1018776R |
| Manifold  | 664639R  | 664640R  |
| Motor Mount Kit   | 904951   | 904951   |
| Orifice (LP)  | 661057R  | 661056R  |
| Orifice (Natural Gas)   | 661049R  | 661047R  |
| Outlet Header Box   | 904802   | 904802   |
| Pressure Switch (Not Shown)   | 632622R  | 632622R  |
| Rollout Limit Switch  | 626609R  | 626609R  |
| Set of Wires (Not Shown, Norydne/UTEC)  | 1028602R | 1028602R |
| Set of Wires (Not Shown, Emerson)<br><i>NOTE: For units manufactured after 09/07/2022</i> | 1040685R | 1040685R |
| Transformer (Not Shown)   | 622341R  | 622341R  |
| Vent Limit Switch   | 626599R  | 626599R  |
| Vent Pipe   | 664644R  | 664644R  |

Please specify Model No., Serial No, and the correct part number(s) when ordering parts from the nearest authorized dealer or service center.

